

by: Gregory L. Johnson
 k. Reg. No. 13484
 ate: 8/15/2017

1010 Lamar, Suite 650 Houston, TX
77002

A-111

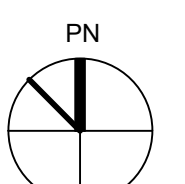
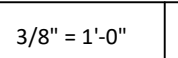
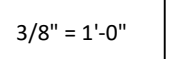
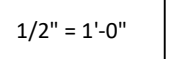
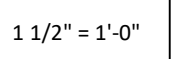
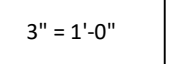

Color: Indian Premium Black
Satin Granite



Water Wall:

Blu-Guard Waterwall WWBG106

Size: 120"H x 72"W x 16"D

Frame Finish: Brushed Stainless Steel

Water Surface: Rain Glass

Base Finish:

Manufacturer: Arizona Tile

Color: Indian Premium Black Granite

Finish: Polished

Cap Finish:

Manufacturer: Arizona Tile

Color: Indian Premium Black Granite

Finish: Polished

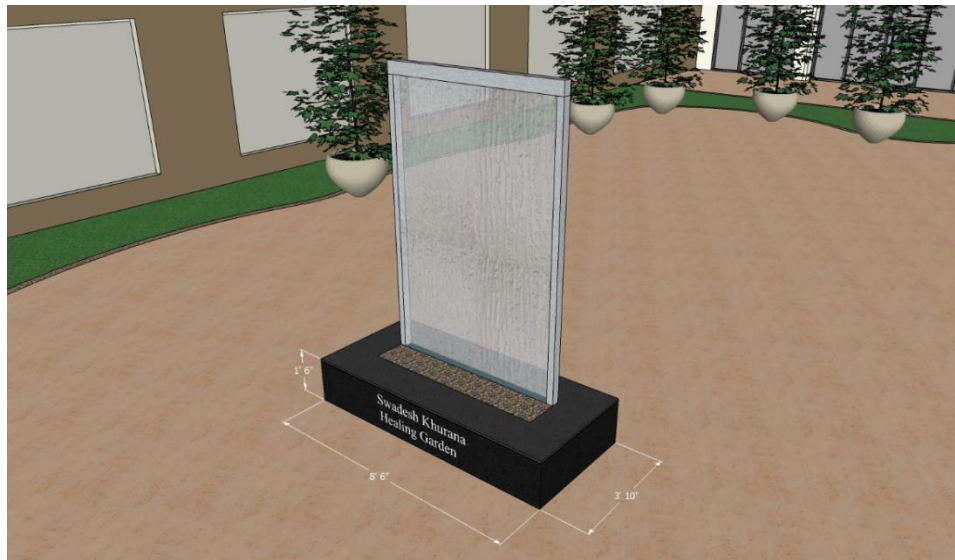

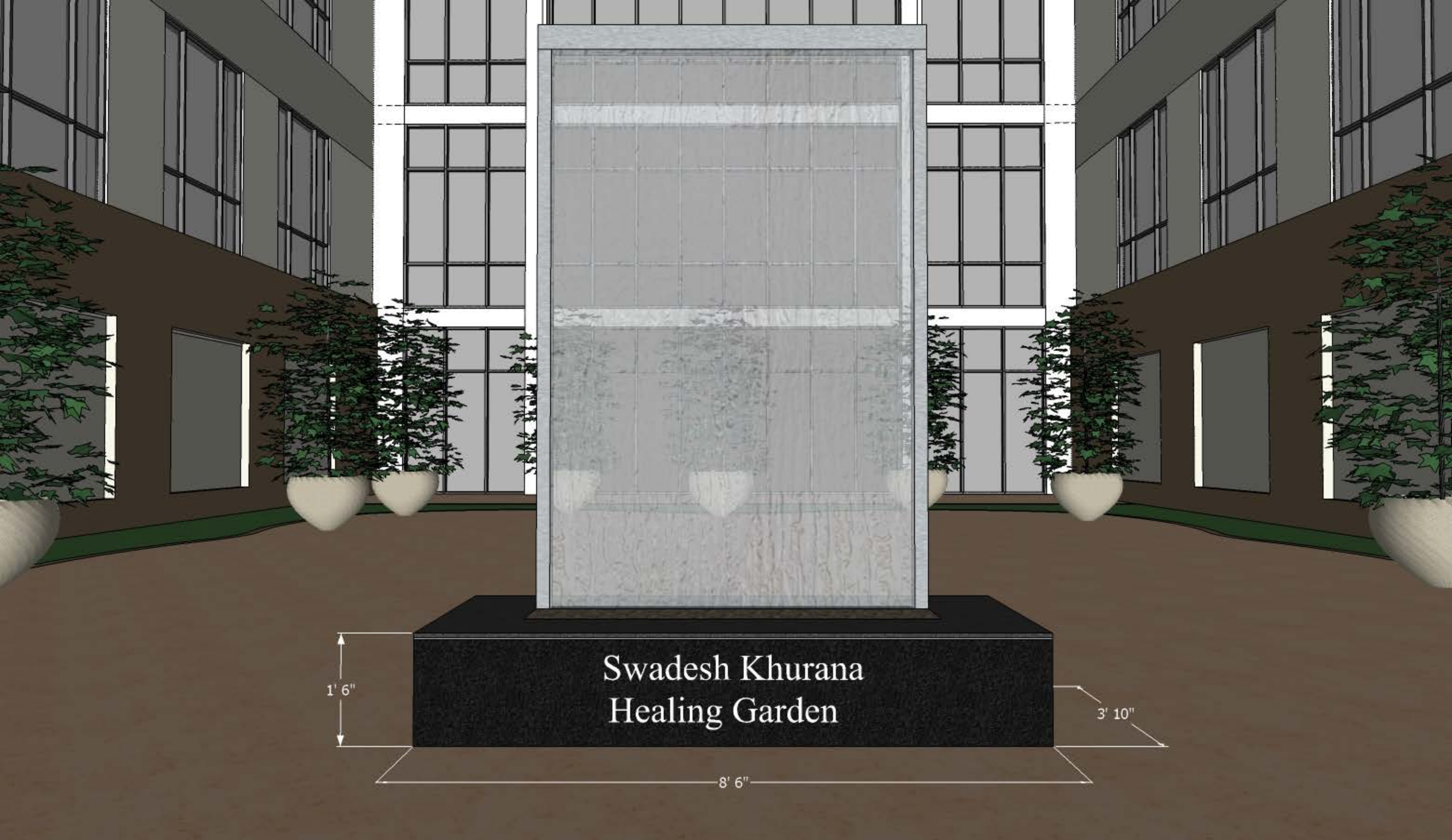

Swadesh Khurana
Healing Garden

1' 6"

8' 6"

3' 10"



Swadesh Khurana
Healing Garden

1' 6"

8' 6"

3' 10"

An architectural rendering of a courtyard. In the center is a tall, narrow glass wall with a grid pattern, reflecting the surrounding environment. On either side of the glass wall are two large, white, heart-shaped planters containing green, leafy plants. The courtyard is flanked by dark brown buildings with large windows. The ground is a light brown color. A dark, textured rectangular block is positioned in the foreground, serving as a base for the title text.

Swadesh Khurana Healing Garden

3' 10"



Swadesh Khurana Healing Garden